

Structure

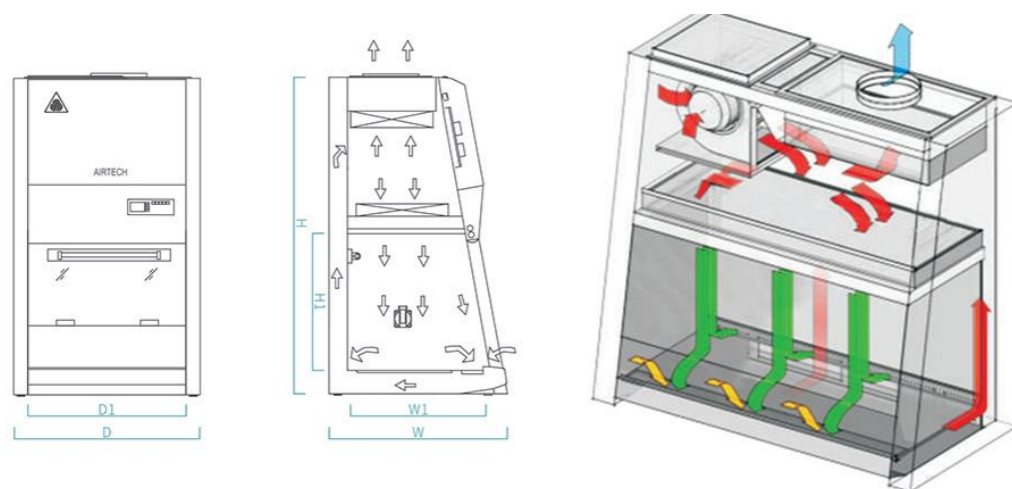

Technical Specification

Model	BSC-654IIA2
Nominal Size	0.65 meter (2')
Filtration Efficiency	≥ 99.995%, @0.3μm
Downflow Velocity	0.33 m/s
Inflow Velocity	0.55 m/s
Noise	≤63 dB (A)
Vibration	≤5 μm (Center of table top)
Power Supply	AC 220~240V, 50/60Hz
Opening Height	200 mm
Personnel Protection	A. Total colony in impaction samplers≤10CFU./time B. Total colony in slot samplers≤5CFU./time
Product Protection	Total colony in culture dish≤5CFU./time
Cross-contamination Protection	Total colony in culture dish≤2CFU./time
Max. Consumption (with spare socket)	0.81 KVA
Rated Power (without spare socket)	0.15 KVA
Weight	110KG
Working Dimension	W650 x D562 x H540mm
Overall Dimension	W750 x D700 x H1200mm
Light Source	LED 13W x 1
Sterilization	UV light 8W x 1
Illumination	≥ 900 Lx
Cabinet Material	High-grade steel and lacquered in ivory
Working Area Material	SUS304 fully finished
Air Direction	Top out

*Ultrassay BioTech Co., Ltd. reserves the right of final interpretation of different specifications.

Ultrassay BioTech Co., Ltd.

Add: RM3018 Poly D9, No. 999 Luzhou Avenue, Baohe District, Hefei, Anhui, China
Tel: +86-551-62881663
E-mail: info@ultrassay.com
Website: <https://ultrassay.com>



Ultrassay® BSC-654IIA2

Desktop Biosafety Cabinet

Ultrassay® BSC-654IIA2 Desktop Biosafety Cabinet is a vertical laminar flow cabinet with 70% circulation, 30% exhaust, mini desktop type, That specially designed for PCR experiments in a small laboratory.

Features

- Small and portable design, placed on the table, suitable for relatively small space.
- The newly designed sliding door lifting and positioning system can be used safely under severe conditions.
- The fan and sliding door linkage design, when the sliding door reaches the working height, the fan can be automatically started.
- DC fan intelligent constant air volume compensation system, when the HEPA filter resistance increases by 50%, the inflow air volume change is less than 10%, ensuring safer operation.



Basic Characteristics

- **Humanizes structure:** 10°sloped front design, demountable circular-arc armrest, working area is made of stainless steel fully finished, equipped with anti-splash safety socket.
- **Safe and reliable:** The sliding door is interlocked with the lighting and sterilization system. The selfmade high-efficiency filter using imported filter material has large dust holding capacity and good uniformity. Adopt negative pressure to surround the double-layer box structure, "leakage resistance" and "unobstructed return air" technology, Through strict cabinet leak prevention testing, high efficiency filter integrity testing, etc.
- **Function control:** It adopts graphic man-machine dialogue interface and touch button controller. The full-color LCD screen displays parameters such as downflow air velocity, inflow air velocity, filter service life and clogging alarm, fan operation status and fault alarm, real-time monitoring and display of BSC running time and other parameters.

